

## Core **ER54/18/18**

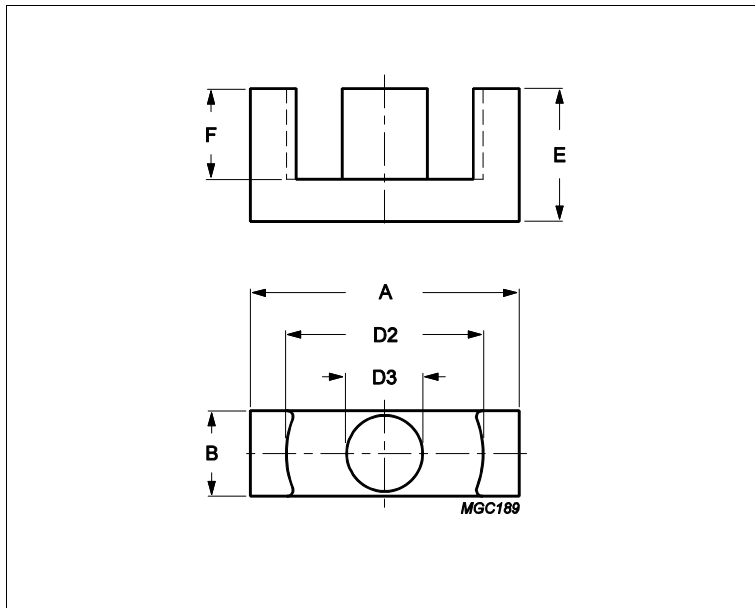

Effective parameters			
	Parameter	Value	Unit
$\Sigma(I/A)$	core factor (C1)	0.37	mm <sup>-1</sup>
<b>Ve</b>	effective volume	23000	mm <sup>3</sup>
<b>Le</b>	effective length	91.8	mm
<b>Ae</b>	effective area	250	mm <sup>2</sup>
<b>Amin</b>	minimum area	240	mm <sup>2</sup>
<b>m</b>	ER54/18/18	≈ 61	g/pcs

Dimensions for product: ER54/18/18						
	Nom	Tol +	Tol -	Max	Min	Unit
<b>A</b>	53.50	1.00	1.00	54.50	52.50	mm
<b>B</b>	17.95	0.35	0.35	18.30	17.60	mm
<b>D2</b>	40.65	0.85	0.85	41.50	39.80	mm
<b>D3</b>	17.90	0.40	0.40	18.30	17.50	mm
<b>E</b>	18.30	0.20	0.20	18.50	18.10	mm
<b>F</b>	11.10	0.30	0.30	11.40	10.80	mm

Inductance factor				
Material	Value	Tol +	Tol -	Unit
3C94	6100	25%	25%	nH/turns <sup>2</sup>

Power loss: 3C94				
Measuring conditions			Max	Unit
100 kHz	200 mT	100 °C	12.000	W/set

Bsat					
Measuring conditions			Material	Min	Unit
25 kHz	250 A/m	100 °C	3C94	320	mT