

LF FOR LEAD FREE

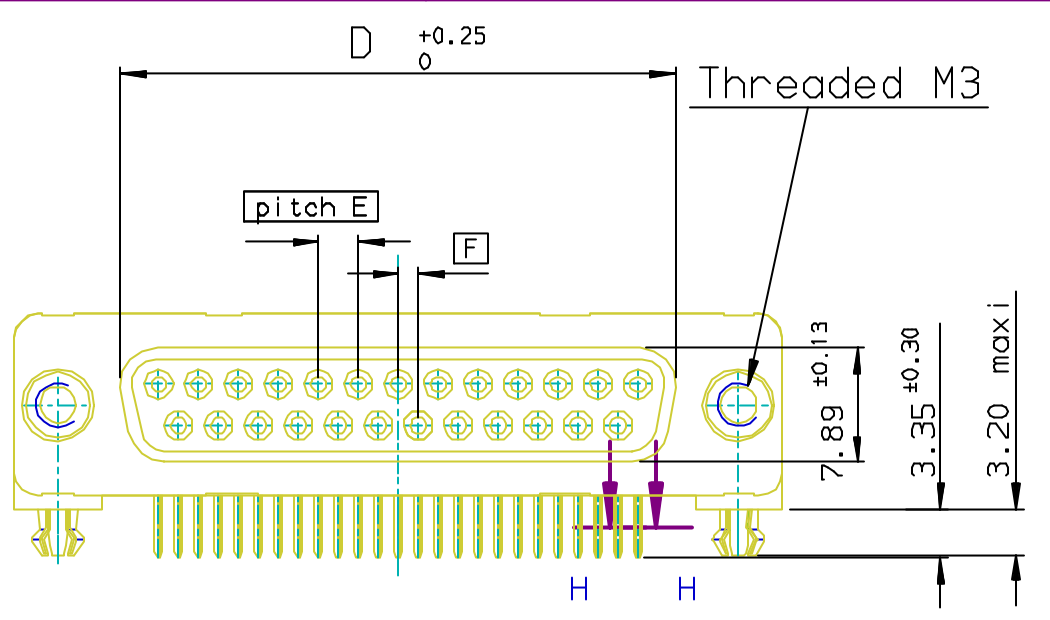

PC card drilling dimensions(after plating)
(thickness 1.60±0.20mm)

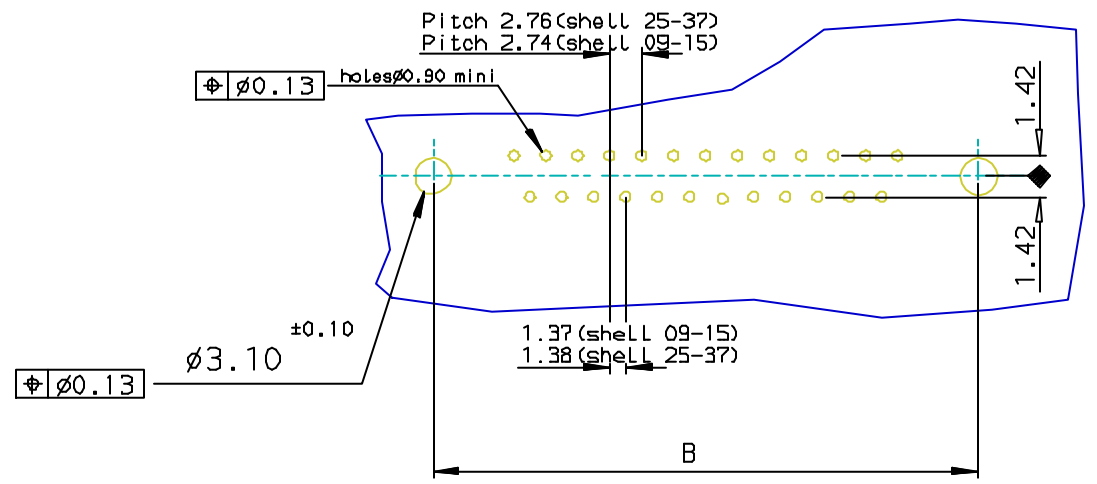

Part Number & Date Code Printing

SHELL	A±0.38	B±0.12	C±0.10	D±0.25	G±0.25	Plating:0.76μ AU
09	30.81	24.99	16.96	16.21	5.90	D09S23B6GL4A**
15	39.14	33.32	25.18	24.54	5.90	D15S23B6GL4A**
25	53.03	47.04	39.12	38.25	5.70	D25S23B6GL4A**
37	69.32	63.50	55.68	54.71	5.70	D37S23B6GL4A**

REQUIREMENTS

Technical characteristics:
 Shell: steel tin/Zinc Cr3 plated
 Insulators: self-extinguishing black polyster, ULclass94V0
 Contacts size 20: phosphor bronze, gold on mating end, bright tin on termination end over nickel on entire contact
 Cycles :500 for protection B

Harpoons: phosphor bronze, tin plated
 Metal plate for electrical continuity: brass, tin/Zinc Cr3 plated
 Nuts: M3 ,brass, tin/Zinc Cr3 plated torque:1.5N/m

Electrical characteristics:
 max.current rating:5A
 Test voltage:1000V
 Rated voltage:300V
 Contact resistance:≤15mΩ
 Shell resistance:≤5mΩ
 Insulation resistance:>5000MΩ

Climatic characteristics:
 Operating temperature range:-55°C +125°C

Dimensions:
 in accordance with MIL-C-24308

FOR ROHS DETAILS REFER DWG.N0:C01-8646-0000

European Views

rev	ecn no	dr	date
C	105-0124	JS	2005/07/27
D	106-0074	SK	2006/06/08
-	-	-	-
-	-	-	-
-	-	-	-
-	-	-	-

www.fciconnect.com		surface ISO 1302 ✓	tolerance std ISO 406 ISO 1101	projection mm
TOLERANCES UNLESS OTHERWISE SPECIFIED				
Dr	JOHN SLEEBA	2001/02/20	ANGULAR	size A3
Eng	GEORGE VJ	2001/02/20	LINEAR	
Chr	GEORGE VJ	2005/07/27	0.XX ±1°	
Appr	KVSD	2005/07/27	Product family	ECN
FCI			D-SUB Spec ref -	
title MALE CONNECT.DELTA D RIGHT ANGLED WITH NUT, HARPOON & METAL PLATE.		dwg no C01-8646-0761		Rev. D
catalog no DELTA-D		CUSTOMER sheet 1 of 1		



Copyright FCI.