

Aug.1.2018 Copyright 2018 HIROSE ELECTRIC CO., LTD. All Rights Reserved.  
 In case that the application demands a high level of reliability, such as automotive,  
 please contact a company representative for further information.

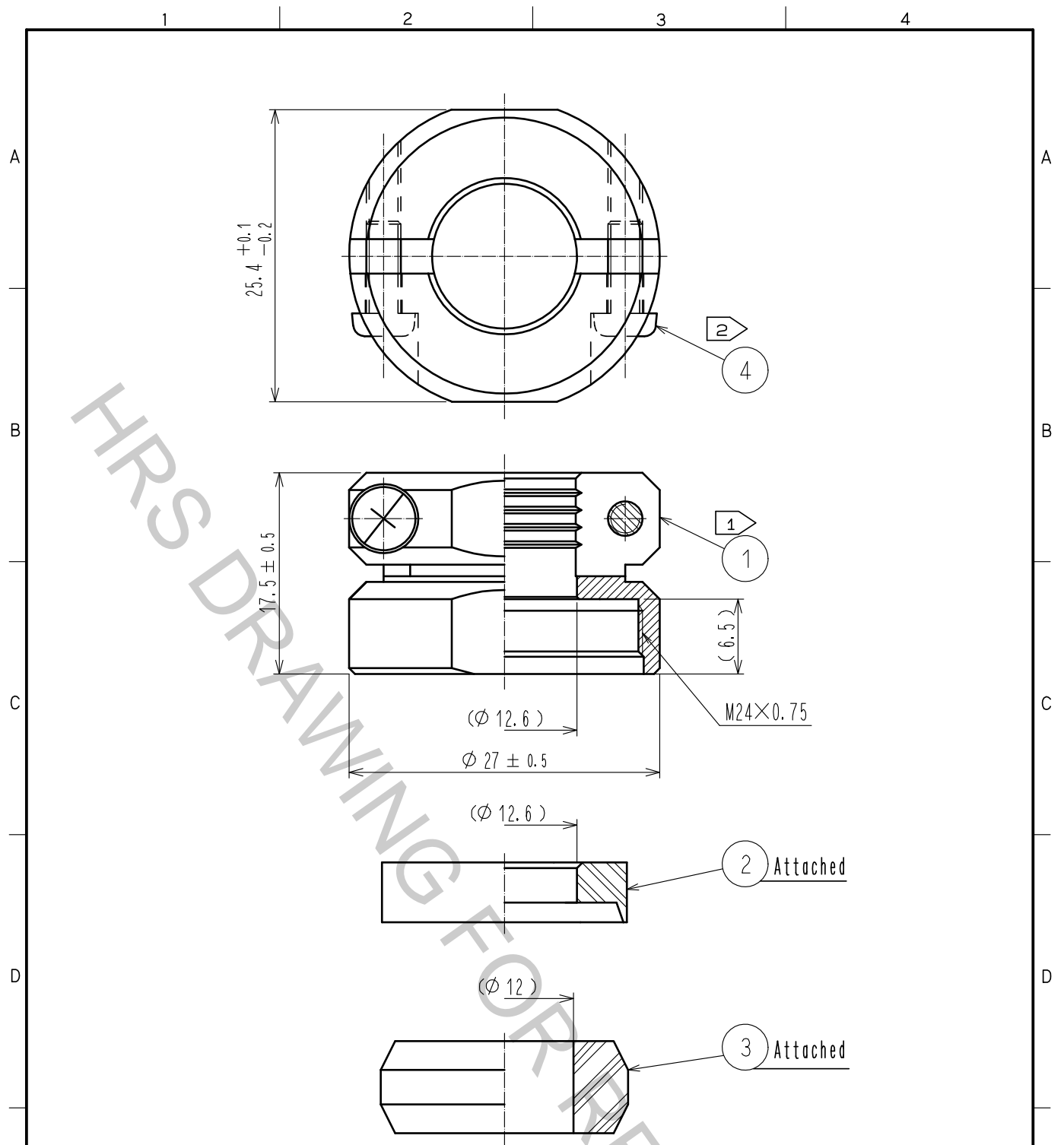

- Notes
- ① The recommended clamp torque of ref. No. ① : 4 to 4.5 N·m .  
 LOCTITE 263, HENKEL JAPAN or equevalent is recommended to prevent  
 ref. No. ① from loosening.
  - ② The recommended clamp torque of ref. No. ④ to be 0.65 to 0.7 N·m .
  - 3. The cable pull and twisting strength, waterproof tightness and other characteristics  
 may differ, depending on the cable structure. Please confirm before the use.

| 2                         | PPS      | ( Black ) UL94V-0       | 4         | Stainless steel                | M3×0.5×8         |         |      |
|---------------------------|----------|-------------------------|-----------|--------------------------------|------------------|---------|------|
| 1                         | Brass    | Black chrome plating    | 3         | Acrylonitrile butadiene rubber | ( Grey )         |         |      |
| NO.                       | MATERIAL | FINISH . REMARKS        | NO.       | MATERIAL                       | FINISH . REMARKS |         |      |
| UNITS<br>mm               |          | SCALE<br>2 : 1          | COUNT<br> | DESCRIPTION OF REVISIONS       | DESIGNED         | CHECKED | DATE |
| HIROSE ELECTRIC CO., LTD. |          | APPROVED :HY. KOBAYASHI | 18.02.26  | DRAWING NO.                    | EDC-110611-31-00 |         |      |
|                           |          | CHECKED :HY. KOBAYASHI  | 18.02.26  | PART NO.                       | JR21WCC-12(31)   |         |      |
|                           |          | DESIGNED :TH. KAMEYA    | 18.02.23  | CODE NO.                       | CL114-2060-4-31  |         |      |
|                           |          | DRAWN :MK. INOUE        | 18.02.14  |                                |                  |         |      |