

LOC		DIST		REVISIONS			
P	LTR	DESCRIPTION	DATE	DMN	APVD		
C		REVISED PER ECO-12-007807	06AUG12	KH	SM		

- 1 UNIT ACCEPTS 1.14 [.045] SQUARE OR ROUND POST.
- 2 PREFERRED SL-156 CONTACTS FOR USE WITH THIS UNIT ARE 350980, 640252, 640706, 640707, 641550 AND 770258 (ALL DASH NUMBERS).
- 3 UNIT ACCEPTS KEYING PLUG 640254-1 AND KEYING PIN 640255-1.
- 4 CIRCUIT I.D. NUMBER(S) TO BE LOCATED SEQUENTIALLY AS SHOWN OR ONLY NO. 1 CIRCUIT PLACED ON TOP OF HOUSING.
- 5 CIRCUITS 5 & 9 ARE MOLDED CLOSED.
- 6 DIMENSIONS IN BRACKETS ARE IN INCHES.

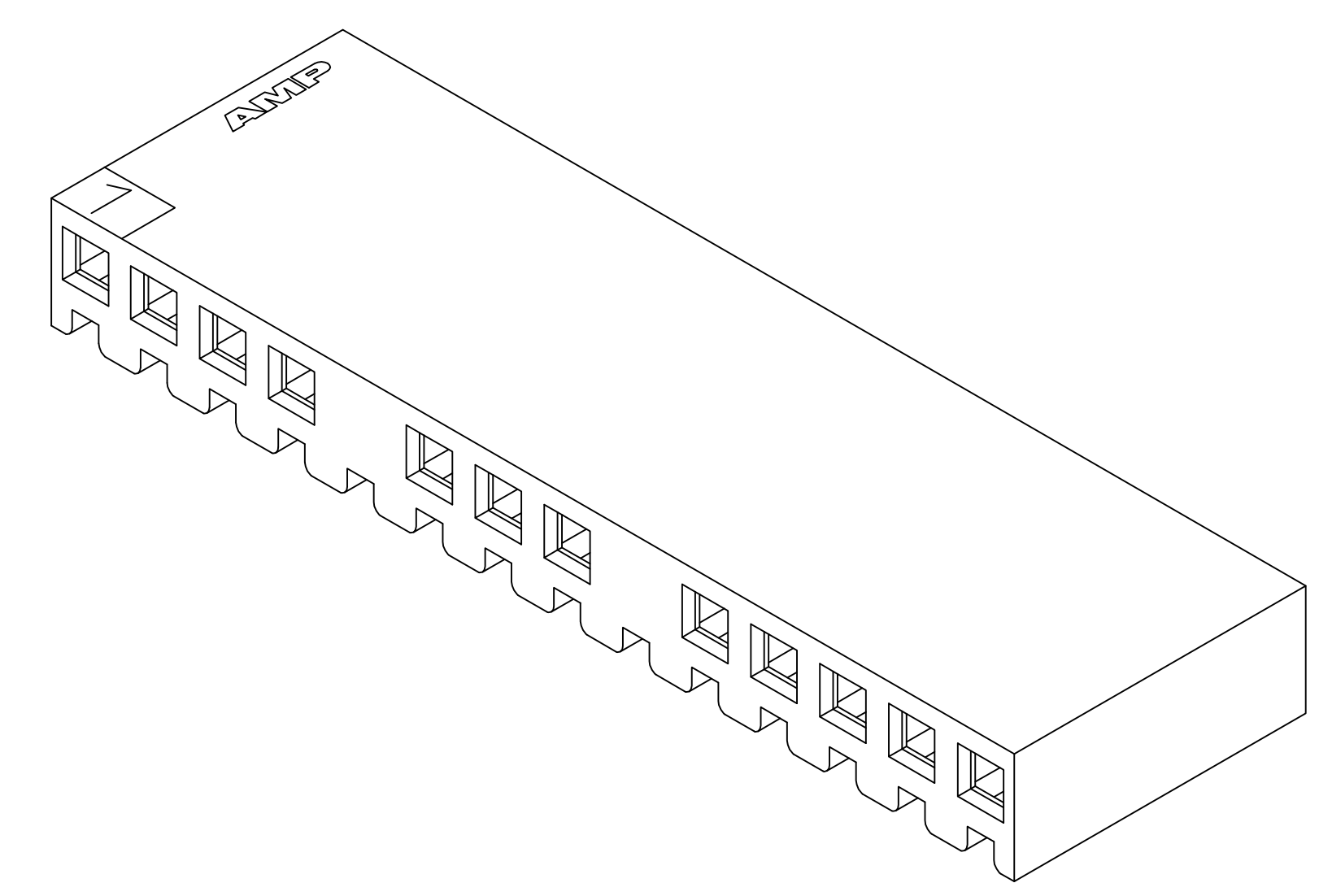

3-DIMENSIONAL MODEL NTS

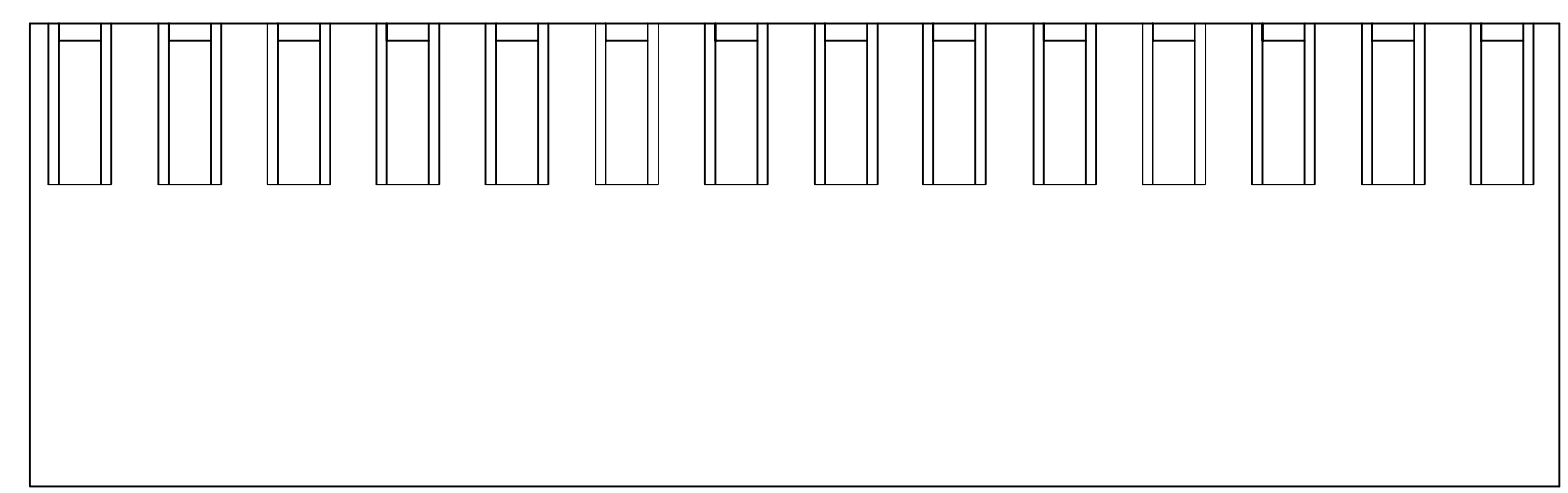
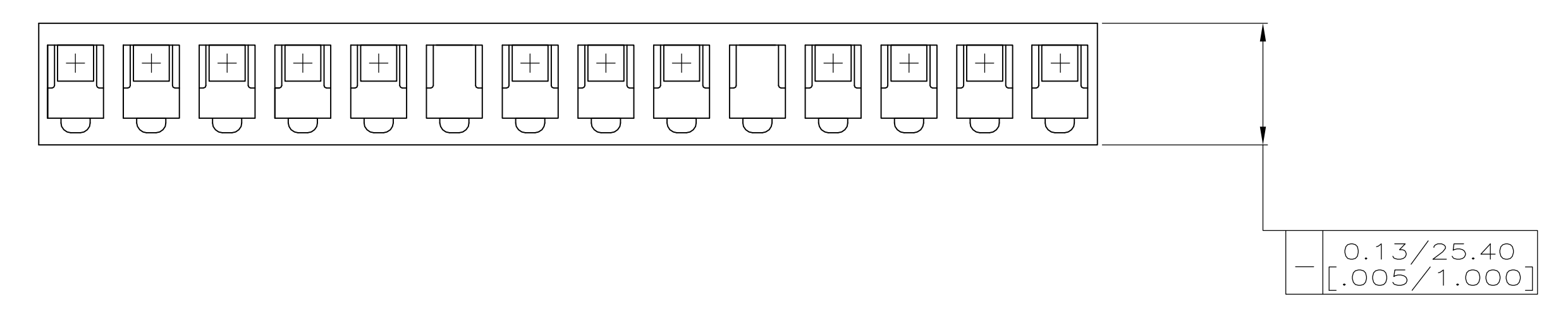
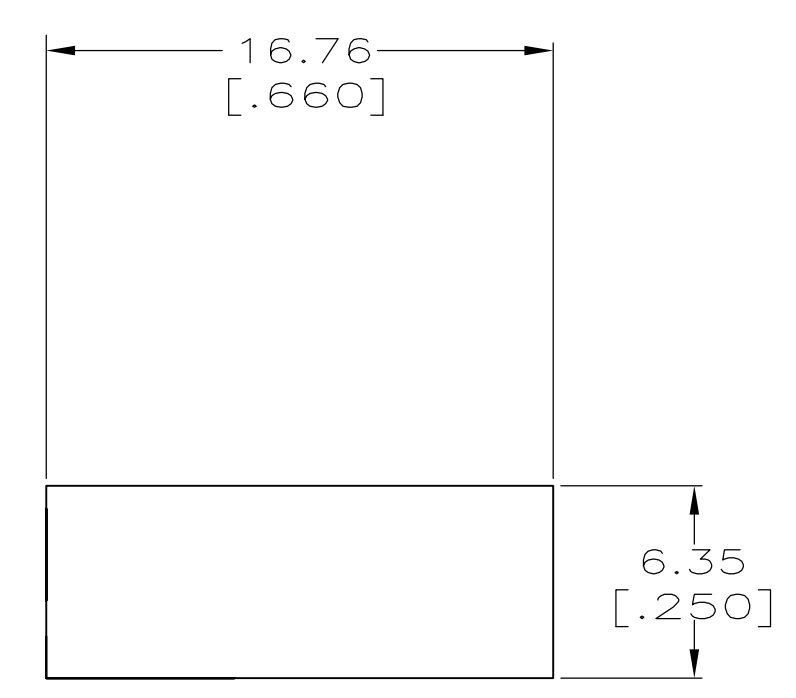
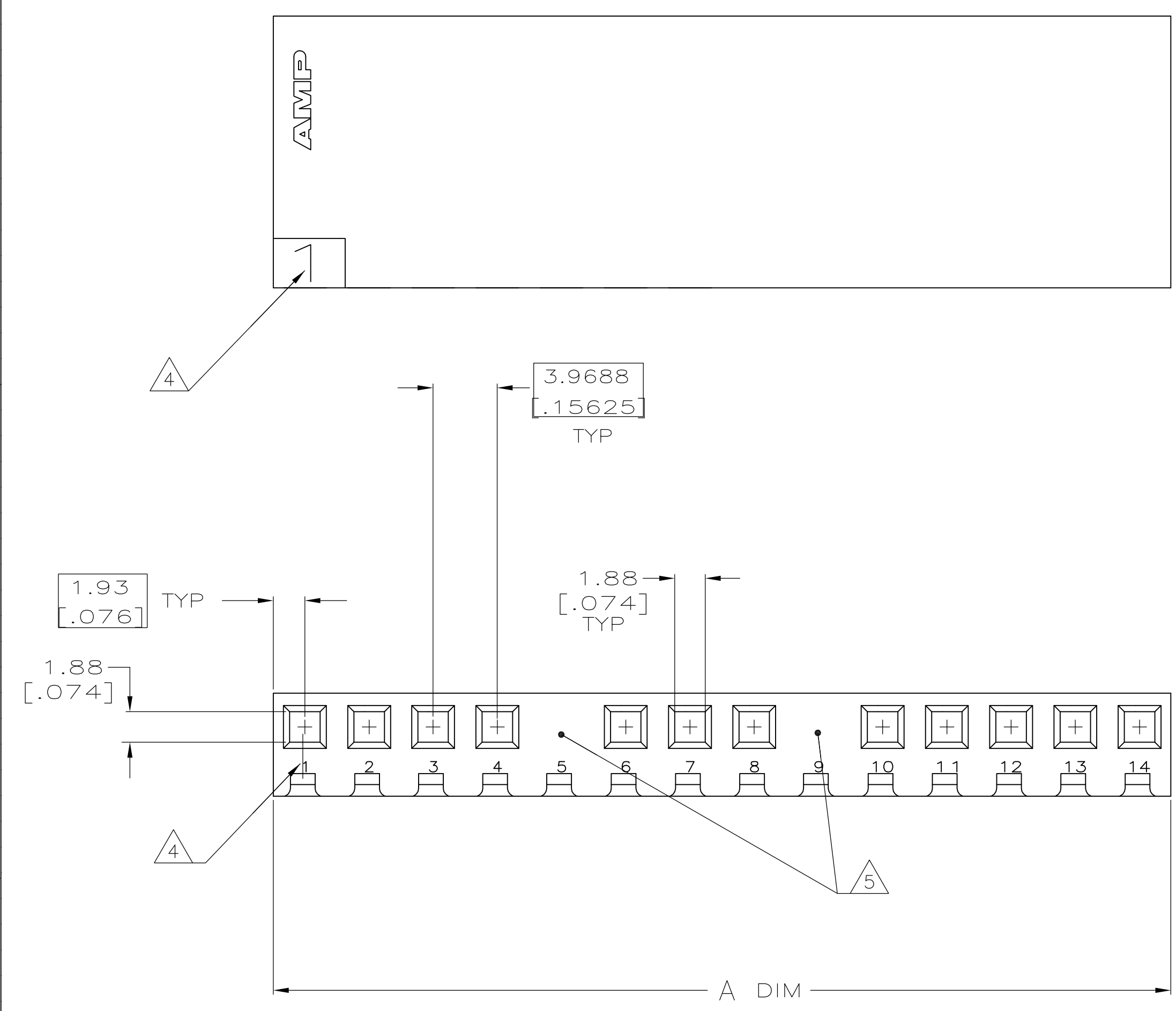
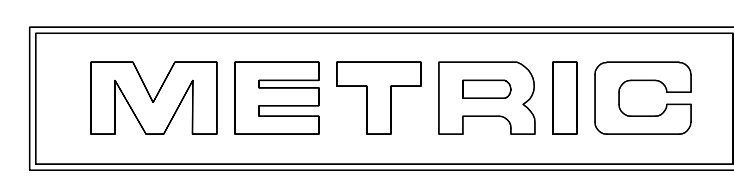

55.45 [2.183]	14	1-770893-4
A ±0.25 [.010]	NO. OF CIRCUITS	PART NUMBER
TE Connectivity		
NAME: HOUSING WITHOUT LOCKING RAMP, CIRCUIT NUMBERS 5 & 9 CLOSED, SL-156		
SIZE: A1    CAGE CODE: 00779    DRAWING NO: 770893    RESTRICTED TO:		
CUSTOMER DRAWING    SCALE: 4:1    SHEET: 1 OF 1    REV: C		

THIS DRAWING IS A CONTROLLED DOCUMENT.	
DIMENSIONS: mm [INCHES]	TOLERANCES UNLESS OTHERWISE SPECIFIED:
0. PLC ± -	1. PLC ± -
2. PLC ± -	3. PLC ± 0.13 [.005]
4. PLC ± -	ANGLES ± -
MATERIAL: NYLON,UL 94V-0 NATURAL	FINISH: -