

### General Purpose Automotive Power Relay

- Standard ISO terminal footprint
- Handles heavy automotive load; inrush current 100A
- High current path fully welded; reduces heat buildup at full load
- Made in North America



### Ordering Information

| Terminal type | Contact form | Cover        | Resistor | Bracket        | Part number               |
|---------------|--------------|--------------|----------|----------------|---------------------------|
| PCB           | SPST-NO      | Standard     | —        | —              | <b>G8J-1A7P-DC12</b>      |
| PCB           | SPST-NO      | Standard     | 680Ω     | —              | <b>G8J-1A7P-R-DC12</b>    |
| Plug In       | SPDT         | Standard     | —        | —              | <b>G8J-1C7T-DC12</b>      |
| Plug In       | SPDT         | Standard     | —        | Molded Plastic | <b>G8J-1C7T-MF-DC12</b>   |
| Plug in       | SPDT         | Standard     | 680Ω     | —              | <b>G8J-1C7T-R-DC12</b>    |
| Plug In       | SPDT         | Standard     | 680Ω     | Molded Plastic | <b>G8J-1C7T-MF-R-DC12</b> |
| Plug In       | SPDT         | Weatherproof | —        | —              | <b>G8J-1C6T-DC12</b>      |
| Plug In       | SPDT         | Weatherproof | 680Ω     | —              | <b>G8J-1C6T-R-DC12</b>    |
| Plug In       | SPDT         | Weatherproof | 680Ω     | Metal          | <b>G8J-1C6T-F-R-DC12</b>  |
| Plug In       | SPDT         | Weatherproof | —        | Metal          | <b>G8J-1C6T-F-DC12</b>    |

### Specifications

#### ■ CONTACT DATA

|  |                 |                             |
|--|-----------------|-----------------------------|
| Max. resistive load                                    | SPST            | 40A                         |
|  | SPDT            | 40A(NO) / 20A(NC)           |
| Contact voltage drop<br>[Initial value at 23°C (73°F)] |                 | ≤150mV(NO) / ≤175mV(NC)     |
| Max. inrush current                                    | Inductive load  | 100A inrush / 20A break(NO) |
|  | Capacitive load | 300A inrush(NO)             |

#### ■ COIL DATA

|                   |   |
|-------------------|---|
| Rated voltage     | 12 VDC                                    |
| Operating voltage | 10-16 VDC                                 |
| Coil resistance   | 78Ω ± 10%                                 |
| Pick-up voltage   | 8V at 23°C (73°F)<br>11V at 125°C (257°F) |
| Dropout voltage   | 1V at 23°C (73°F)                         |

## CHARACTERISTICS

|   |   |
|---|---|
| Operate time at 23°C (73°F)                       | 5 ms max.   |
| Release time at 23°C (73°F)                       | 4 ms max.   |
| Duty cycle at rated load<br>[16V at 80°C (176°F)] | Up to 100%  |
| Mechanical life                                   | 10,000,000 operations minimum at 18,000 operations/hour |
| Electrical life (resistive load)                  | 100,000 operations minimum (14V / 35A)                  |
| Operating ambient temperature                     | -40° to 125°C (-40° to 257°F)                           |
| Weight  | Approx. 40g   |

Note: Data shown are of initial value.

## Dimensions

Unit: mm (inch)

### SPST PCB TYPE

G8J-1A7P-\_\_

#### Circuit Diagram

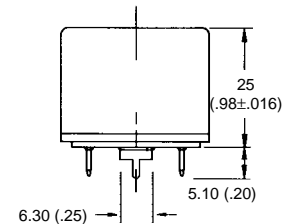
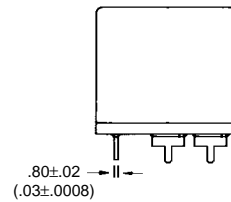
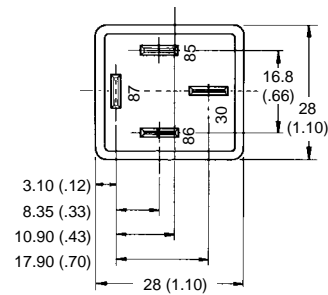
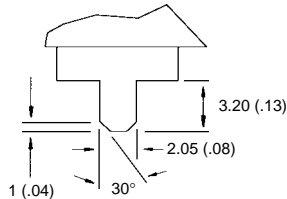
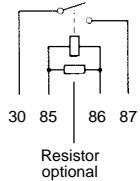

### SPDT PLUG-IN TYPE

G8J-1C7T-\_\_

#### Circuit Diagram

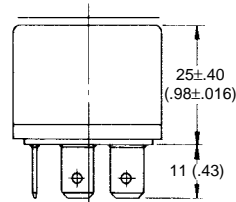
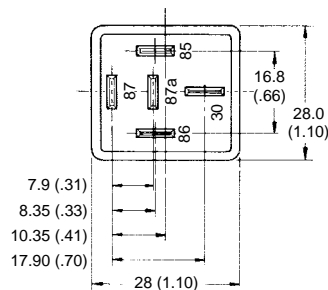
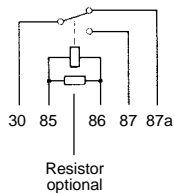

Standard Package

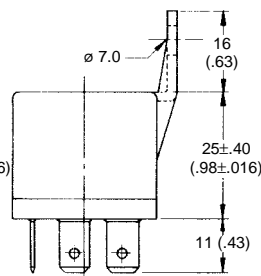

Plastic Bracket Optional

## ■ SPDT PLUG-IN WEATHERPROOF TYPE

G8J-1C6T-\_\_\_

### Circuit Diagram

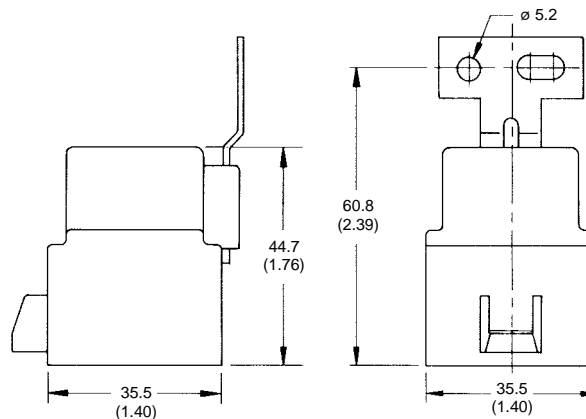
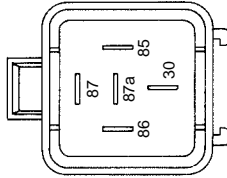
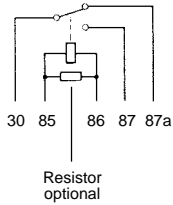

**Metal Bracket  
Optional**

Note: In the interest of product improvement, specifications are subject to change.

# OMRON

**OMRON ELECTRONICS, INC.**

One East Commerce Drive  
Schaumburg, IL 60173  
**1-800-55-OMRON**

Cat. No. GC RLY6

9/97

Specifications subject to change without notice.

**OMRON CANADA, INC.**

885 Milner Avenue  
Scarborough, Ontario M1B 5V8  
**416-286-6465**

Printed in the U.S.A.