

for EMC, features,
conductive surface

range of delivery:
housing: zinc die-casting alloy,
black powder coated
seals: 1 o-ring, 1 gasket
insert fixing screw for IP 68

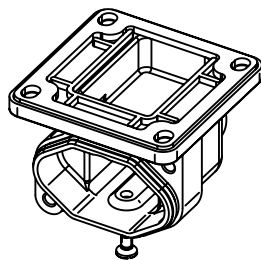
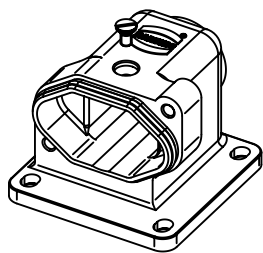

	All Dimensions in mm Original Size DIN A4		Scale 1:1	Free size tol.		Ref.	
	All rights reserved Department EL PD - DE		Created by RULLKOETTER	Inspected by SCHNIEDER	Standardisation TIEMANNA	Date 2014-10-20	State Final Release
HARTING Electric GmbH & Co. KG D-32339 Espelkamp		Title Han 3HPR angled housing M20, RoHS conf.				Doc-Key / ECM-Nr. 100176351/UGD/004/A 500000080841	
		Type TB	Number 19 40 703 0950			Rev. A	Page 1/1