

1

2

3

4

A

B

C

D

A

B

C

D

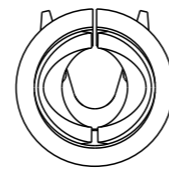
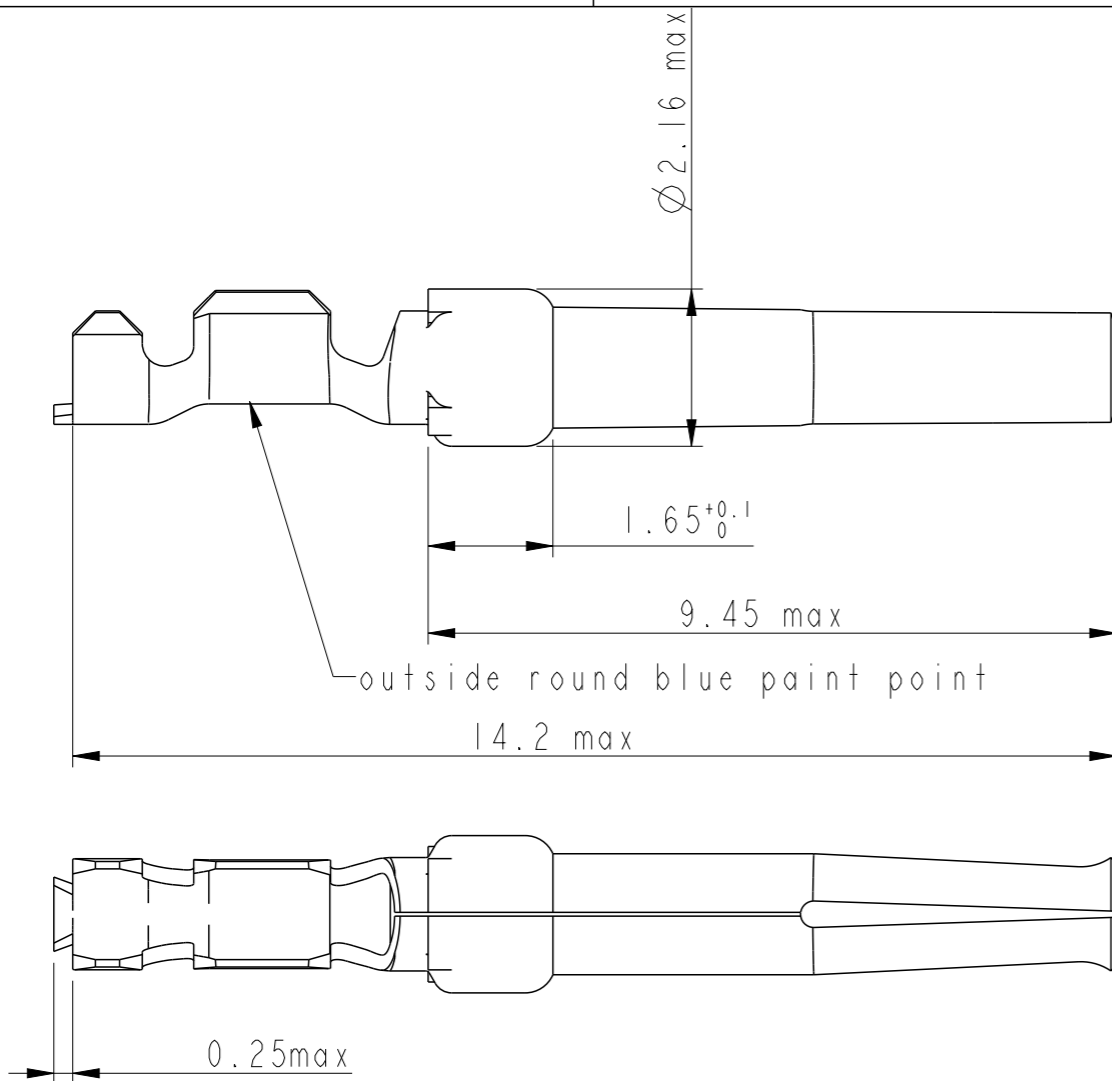

NOTES:

- 1-Material:phosphor bronze,thickness 0.20
- 2-Finish on contact area:see table  
finish on termination:bright tin over nickel
- 3-Wire range:24-28 AWG
- 4-Max outer dia of wire insulator:1.02 mm
- 5-Current carrying capacity per contact:
  - 3.Amps max when crimped to #24 AWG
  - 2 Amps max when crimped to #26 AWG
  - 1 Amps max when crimped to #28 AWG
- 6-After 5 insertions into connector, contact retention must be 5 pounds axial load min
- 7-When contact is crimped to 24 AWG,the insulation support crimped height must be 1.78 mm max to ensure a proper insertion into housing
- 6-Packaging:Box of 500 contacts

NOTE : ROHS INFORMATIONS

The LF products meet European union directives and other country regulations as described in GS-22-008  
 Terminations plating spec : 2um Nickel min + 2um Sn min  
 Packaging Spec : see GS-14-920

| PART NUMBER         | Plating       |
|---------------------|---------------|
| <b>8656451067LF</b> | 0.4μ Au / GXT |
| <b>8656451067</b>   | 0.4μ Au / GXT |

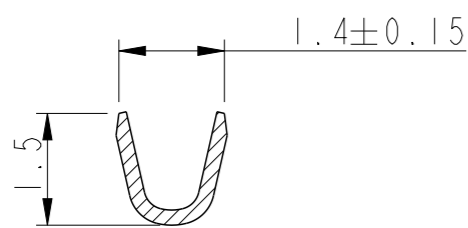

SECTION A-A

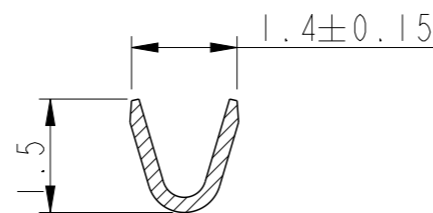

SECTION B-B



Copyright FCI.

| rev | ecn no    | dr  | date       |
|-----|-----------|-----|------------|
| C   | LS06-196  | MPE | 27/11/2006 |
| D   | LS08-0127 | MPE | 13/05/2008 |
| E   | LS08-0216 | MPE | 26/11/2008 |
| F   | 109-0128  | AMR | 2009-07-07 |
| G   | 109-0152  | AMR | 2009-07-29 |
| H   | 110-0070  | AMR | 2010-03-09 |
| J   | 111-0003  | AMR | 2011-01-06 |

|                    |              |                                       |                                   |                       |
|--------------------|--------------|---------------------------------------|-----------------------------------|-----------------------|
| www.fciconnect.com |              | surface - ✓<br>ISO 1302               | tolerance std<br>ISO 406 ISO 1101 | projection<br>mm      |
|                    |              | TOLERANCES UNLESS OTHERWISE SPECIFIED |                                   | ←→                    |
| Dr                 | C JARRY      | 1997-01-28                            | ANGULAR                           | size A3               |
| Eng                | ABHILASH M R | 2009-07-07                            | LINEAR                            | Scale 10:1            |
| Chr                | ABHILASH M R | 2009-07-07                            | 0° ±2°                            | ECN 111-0003          |
| Appr               | SUDHIR VARMA | 2009-07-07                            | Product family                    | Spec ref              |
| FCI                |              | CRIMP SOCKET                          |                                   | Rev. J                |
|                    |              | #Wire 24-28 Ø1.02 max                 |                                   | dwg no C01-8656-0418  |
|                    |              | catalog no                            |                                   | CUSTOMER sheet 1 of 1 |

1

2

3