

PART NO.	CKT SIZE	PACKAGING
87526-5220	20	T/REEL
87526-5320	20	TUBE

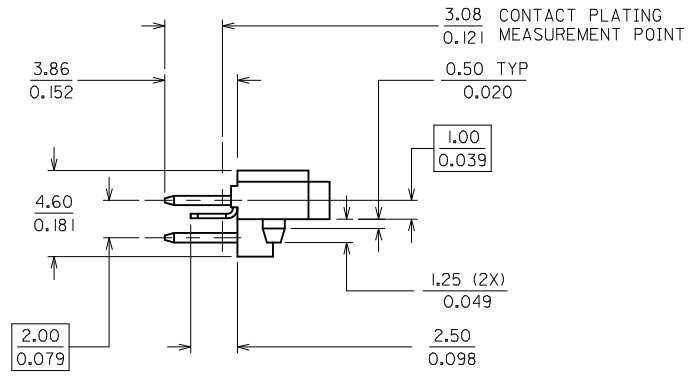

- NOTES:
1. PRODUCT SPECS: PS-87526-0001
 2. COPLANARITY OF SOLDERTAIL AND FITTING NAILS ARE TO BE MEASURED BY RESTING THE PART ON A FLAT GAUGED SURFACE.
 3. MATERIALS:
 - HOUSING: LCP, GLASS FILLED, UL94V-0, COLOR: BLACK
 - TERMINALS: PHOS BRONZE WITH PLATING 0.38µM MIN GOLD ON MATING END
 - 1.90µM MIN TIN ON SOLDERTAIL BOTH OVER
 - 1.30µM MIN NICKEL UNDERPLATE
 - FITTING NAILS: BRASS WITH PLATING 1.90µM AND 1.30µM NICKEL UNDERPLATE
 4. SECONDARY DIMENSION FOR REFERENCE ONLY
 5. PACKAGING SPECIFICATIONS:
 - TUBE: PK-87526-0001 , TAPE & REEL: PK-87526-0002

ADD NOTE 5 EC NO: S2017-0079 DRAWN: EMARLY 2016/08/02 CHYK: SCHEONG 2016/08/16 APPR: KHLIM 2016/08/17	QUALITY SYMBOLS $F_A=0$ $F_G=0$ $F_P=0$	GENERAL TOLERANCES (UNLESS SPECIFIED)		DIMENSION STYLE		SCALE	DESIGN UNITS	THIRD ANGLE PROJECTION	
				MM/IN		NTS	METRIC		
				mm	INCH	TITLE			
						MGRID, I/O HEADER 4.60MM HT. WITH FITTING NAIL (BIG FOOT)			
1	DESCRIPTION	DRAWN BY		DATE		MATERIAL NO.		DOCUMENT NO.	
		JLIM		1995/06/08		SD-87526-5020		SHEET NO.	
		CHECKED BY		DATE		THIS DRAWING CONTAINS INFORMATION THAT IS PROPRIETARY TO MOLEX INCORPORATED AND SHOULD NOT BE USED WITHOUT WRITTEN PERMISSION		1 OF 3	
		SKTOH		1995/08/03					
APPROVED BY		DATE							
RWONG		1995/08/04							
ANGULAR ± 3 °									
DRAFT WHERE APPLICABLE MUST REMAIN WITHIN DIMENSIONS									

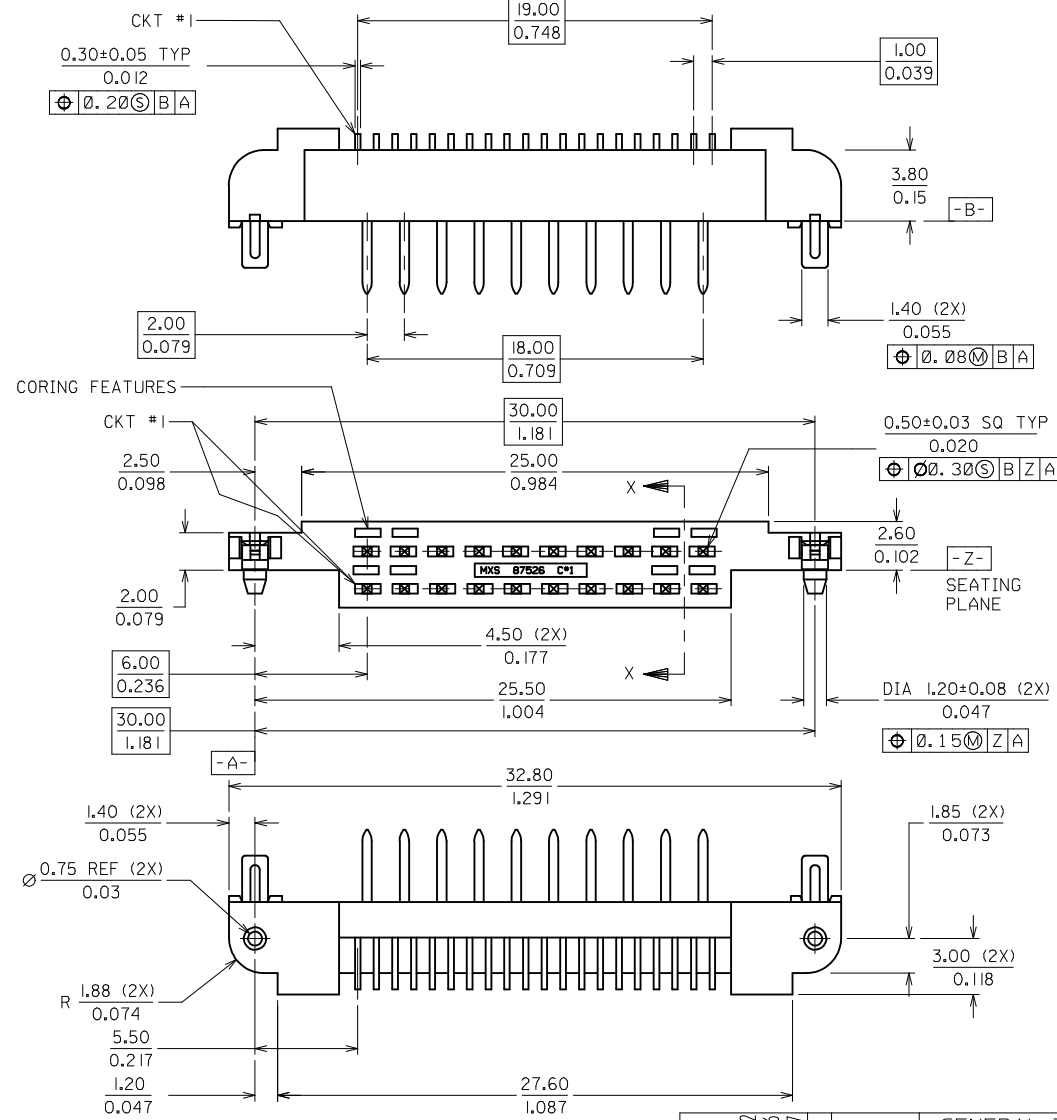
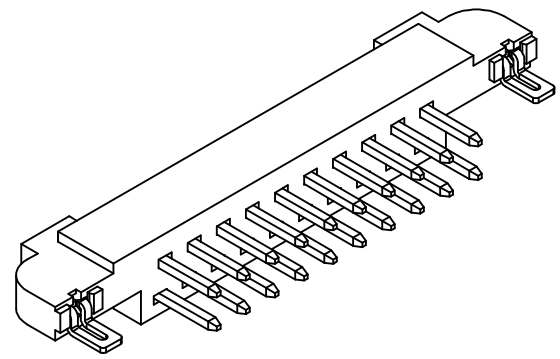
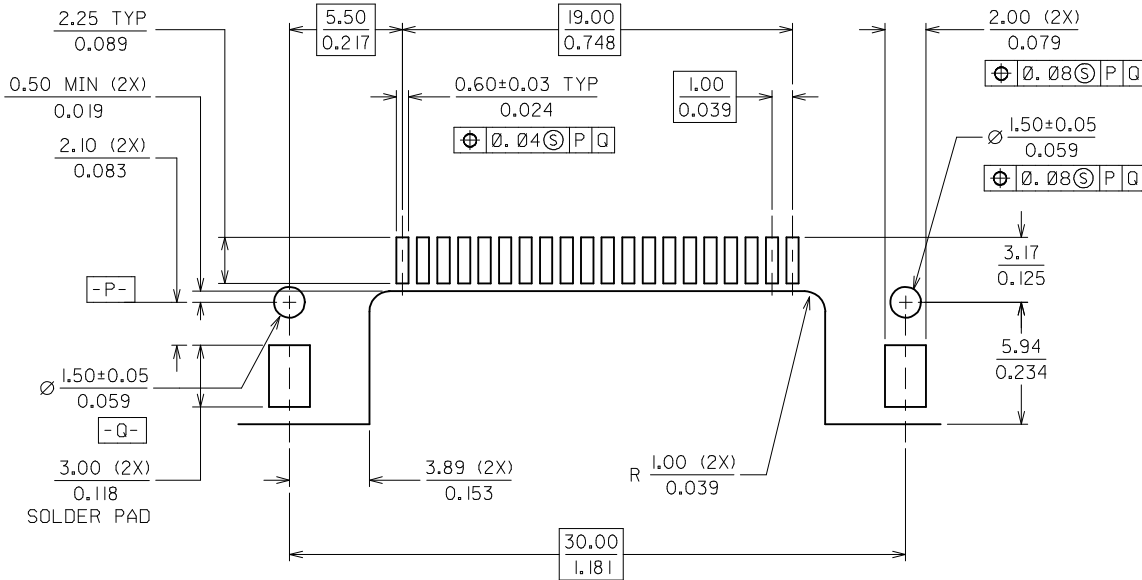

ISO VIEW
(CORING NOT SHOWN AND NOT TO SCALE)

RECOMMENDED PCB LAYOUT

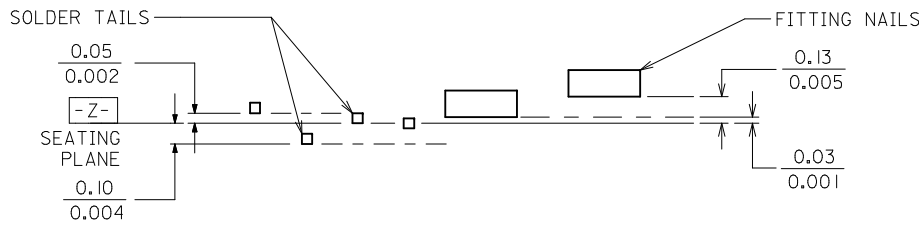

VIEW Y-Y
COPLANARITY CONTROL
(FOR ILLUSTRATION ONLY)

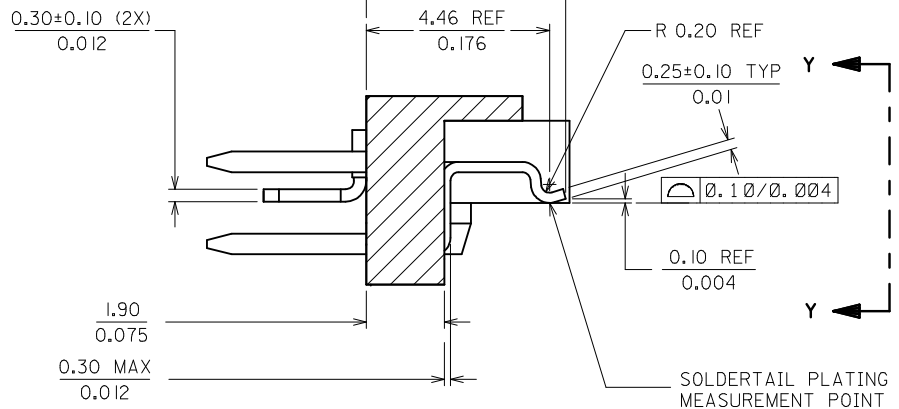

SECTION X-X
(SCALE 8:1)

SEE SHEET 1 EC NO: S2017-0079 DRWG:MEMARLY 2016/08/02 CHKD:SCHEONG 2016/08/16 APPR:KHL IM 2016/08/17	QUALITY SYMBOLS $\nabla_{\sigma} = 0$ $\nabla_{\sigma} = 0$ $\nabla_{\sigma} = 0$	GENERAL TOLERANCES (UNLESS SPECIFIED)		DIMENSION STYLE		SCALE	DESIGN UNITS	THIRD ANGLE PROJECTION		
		mm	INCH	MM/IN		NTS	METRIC			
		4 PLACES	± ---	± ---	DRAWN BY	DATE	TITLE			
		3 PLACES	± ---	± ---	JL IM	1995/06/08	MGRID, I/O HEADER 4.60MM HT. WITH FITTING NAIL (BIG FOOT)			
2 PLACES	± 0.13	± ---	CHECKED BY	DATE	molex MATERIAL NO. SD-87526-5020 DOCUMENT NO. SHEET NO. 2 OF 3					
1 PLACE	± ---	± ---	SKTOH	1995/08/03						
0 PLACE	±	±	APPROVED BY	DATE						
			RWONG	1995/08/04						
DRAFT WHERE APPLICABLE MUST REMAIN WITHIN DIMENSIONS		ANGULAR ± 3°		SEE TABLE						
THIS DRAWING CONTAINS INFORMATION THAT IS PROPRIETARY TO MOLEX INCORPORATED AND SHOULD NOT BE USED WITHOUT WRITTEN PERMISSION										

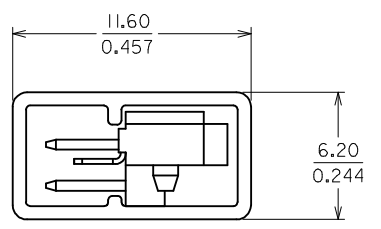
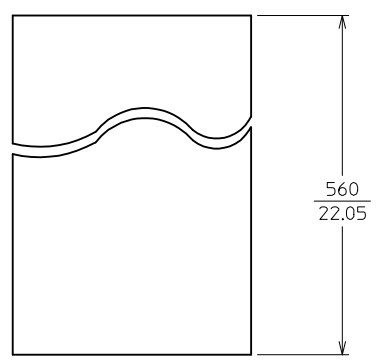

TUBE ORIENTATION
(16 PCS / TUBE)

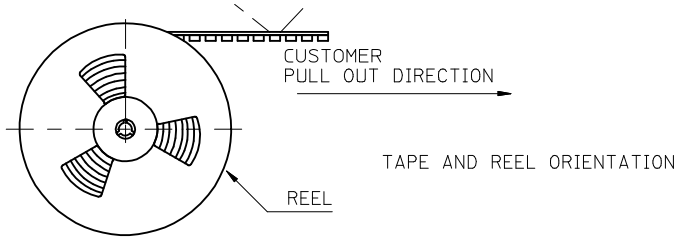
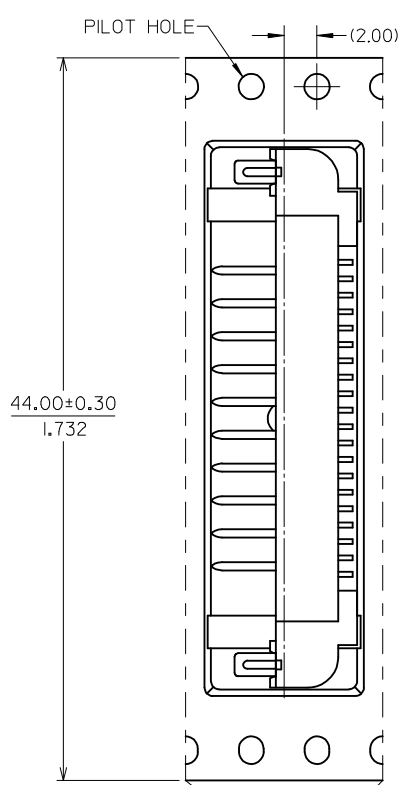

NOTES:

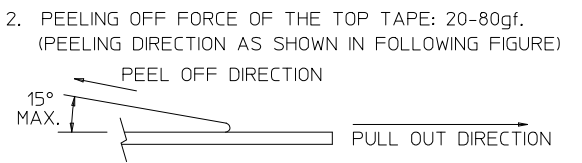
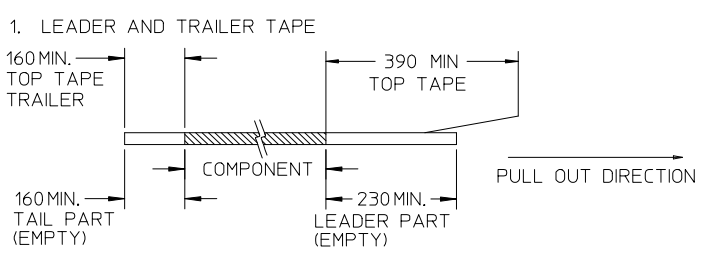

3. PACKAGING STANDARD IS AS PER EIA-481.
4. TAPE & REEL QUANTITY = 1000PCS/REEL

SEE SHEET 1	EC NO: S2017-0079	QUALITY SYMBOLS	GENERAL TOLERANCES (UNLESS SPECIFIED)		DIMENSION STYLE	SCALE	DESIGN UNITS	THIRD ANGLE PROJECTION
	DRWN:GEMARLY 2016/08/02		mm	INCH	MM/IN	NTS	METRIC	
	CHKD:SCHEONG 2016/08/16		4 PLACES ± --- ± ---	3 PLACES ± --- ± ---	DRAWN BY	DATE	TITLE	
	APPR:KHLIM 2016/08/17		2 PLACES ± 0.13 ± ---	1 PLACE ± --- ± ---	JLIM	1995/06/08	MGRID, I/O HEADER 4.60MM HT. WITH FITTING NAIL (BIG FOOT)	
			0 PLACE ± ±	3 PLACES ± --- ± ---	CHECKED BY	DATE		
			ANGULAR ± 3 °	2 PLACES ± 0.13 ± ---	SKTOH	1995/08/03		
			DRAFT WHERE APPLICABLE MUST REMAIN WITHIN DIMENSIONS	1 PLACE ± --- ± ---	APPROVED BY	DATE		
				0 PLACE ± ±	RWONG	1995/08/04		
					MATERIAL NO.	DOCUMENT NO.		
					SEE TABLE	SD-87526-5020		
					SIZE A3	THIS DRAWING CONTAINS INFORMATION THAT IS PROPRIETARY TO MOLEX INCORPORATED AND SHOULD NOT BE USED WITHOUT WRITTEN PERMISSION		
								SHEET NO. 3 OF 3