

PART NUMBER	REV	FIRST USED
567915-1	C	854040-3

TERMINAL NAME: DOUBLE LOCK POWER CONNECTOR		CRIMPING DATA			
VISIBLE PAD LTR	CRIMP HEIGHT	WIRE SIZE			
A	.051 ±.002 [1.29 ±0.05mm]	1.25mm ²			
B	.045 ±.002 [1.15 ±0.05mm]	0.85mm ²			
C	.041 ±.002 [1.05 ±0.05mm]	0.5mm ²			
D	NOT	USED			
CRIMP WIRE	SIZE	TYPE	RANGE		
	.080 [2.03mm]	F	0.5mm ² -1.25mm ²		
	.130 [3.3mm]	F	1.8mm-3.1mm		
WIRE STRIP LENGTH	TERM APPL SPEC	FEED	APPL INSTRUCTION	SET UP GAGE	LAYOUT
-	114-5175	.429		NONE	L16845C

QTY	REV	DESCRIPTION	ITEM NO		
2	-	A	22278-9	SPRING, COMPRESSION	65
1	-	A	4-21028-0	PIN, SLOTTED SPRING	64
1	-	A	455053-1	PLATE, RETAINING	63
1	-	B	455052-1	CARRIER, HOLD DOWN	62
1	-	C	459551-1	HOLD DOWN, TERMINAL	61

QTY	REV	DESCRIPTION	ITEM NO		
2	-	C	3-354779-2	PIN, WIRE DISC (.3150)D	129
2	-	C	2-354779-0	PIN, WIRE DISC (.3090)C	128
2	-	C	4-354779-0	PIN, WIRE DISC (.3190)A	126
1	-	A	986950-1	WASHER, FLAT PRECISION	125
1	-	B	690701-2	PLATE, SERIAL NO.	124
1	-	A	4-21028-0	PIN, SLT SPR (Ø.093x.75)ST GDE PL	121
2	-	A	21899-2	WASHER, FLAT (#10)S G ADJ BLK	119
2	-	A	21024-5	WASHER, LOCK (#10)ADJ BLOCK	117
2	-	A	21024-2	WASHER, LOCK (#4)FRONT STP GUIDE	114
REF	-	A	21024-4	WASHER, LOCK (#8)FEED FINGER	113
2	-	A	21024-4	WASHER, LOCK (#8)DEP-HOLD	112
REF	-	A	21024-4	WASHER, LOCK (#8)STRIPPER	111
4	-	A	21017-2	SCR, DRIVE (#2x.19)ID PLATE	101
1	-	B	819347-1	PLATE, IDENTIFICATION	100
2	-	A	3-21002-0	SCR, BHC (10-32x.88)DRAG	99
1	-	A	22733-8	SCR, BHC (8-32x.38 LW)ANVIL	98
1	-	A	3-21000-8	SCR, SHC (10-32x.88)MOUNTING	96
1	-	A	2-21002-7	SCR, BHC (10-32x.50)SG ADJ BLK	95
6	-	A	2-21002-2	SCR, BHC (8-32x.50)SHEAR-TERM SUP	94
1	-	A	1-21002-7	SCR, SHC (6-32x.50)CAM	91
2	-	A	2-21000-7	SCR, SHC (8-32x.50)SCR BLK	90
2	-	A	9-21002-6	SCR, SHC (8-32x.86)DEP-HOLD DOWN	87
REF	-	A	2-22603-0	SCR, HEX HD (8-32x.31)FEED FINGER	86
2	-	A	1-21000-3	SCR, SHC (4-40x.25)F ST GUIDE	85
REF	-	A	22733-9	SCR, BHC (8-32x.50 SL)STRIPPER	84
1	-	A	3-22603-1	SCR, HEX (10-32x.38)SG ADJ BL	81
2	-	B	463310-4	BLADE, STRIPPING (#18)	77
1	-	A	690603-1	SPRING, ASSIST	74
1	-	A	23030-1	SCR, 5KT CAP (6-32x.25)CP DSC	73

QTY	REV	DESCRIPTION	ITEM NO		
1	-	A	690602-6	CAM, PRE-FEED 1.62 STROKE	48
1	-	A	690191-1	PLUG, NYLON	45
1	-	C	455673-1	RAM	44
1	-	A	690125-1	WASHER, LAMINATED	43
1	-	A	690124-1	WASHER, RAM	42
1	-	A	7-21002-9	BOLT, CRIMPER (5/16x1.00)	41
1	-	A	23241-6	BALL, STEEL	40
1	-	A	690170-1	SPRING, COMPRESSION	39
1	-	C	690142-4	DISC, INSULATION	38
1	-	D	354777-1	WIRE DISC, PLASTIC	37
1	-	A	22480-5	WASHER, SPRING	36
1	-	B	690212-1	POST, RAM	35
1	-	B	1-690786-9	SUPPORT, TERMINAL	34
1	-	C	462544-1	PLATE, BASE SPECIAL	33
1	-	A	690432-3	SCREW, ADJUSTMENT	32
1	-	B	462543-1	BLOCK, SCREW SPECIAL	31
1	-	B	455689-1	BLOCK, STRIP GUIDE ADJ	30
1	-	C	455671-1	PLATE, STRIP GUIDE	29
1	-	C	455888-4	SPACER, FRONT SHEAR DEP	28
2	-	A	1-22284-0	SPRING, DRAG	27
1	-	B	690546-1	LEVER, DRAG RELEASE	26
1	-	B	240792-1	DRAG, TERMINAL	25
1	-	D	6-690504-8	GUIDE, STRIP (REAR)	24
1	-	A	690438-1	GUIDE, STRIP (FRONT)	23
1	-	A	463756-1	GUIDE, SCRAP	21
1	-	C	462615-4	STRIPPER	19
1	-	A	318596-1	CRIMPER, SPECIAL	13
1	-	A	6-22279-4	SPRING, SHEAR	12
1	-	B	690461-2	STOP, SHEAR (FRONT)	11
1	-	B	462548-3	HOLDER, SHEAR (FRONT) SP	10
1	-	B	462547-3	SHEAR, FLOAT (FRONT) SP	9
1	-	C	3-189717-7	ANVIL	8
1	-	A	462838-1	DEPRESSOR, SHEAR (FRONT) SP	5
1	-	B	2-238011-1	SPACER, BLOCK CRIMPER	4
1	-	C	4-456134-2	CRIMPER, INSULATION	3
1	-	C	455888-2	SPACER, CRIMPER	2
1	-	C	1-456405-2	CRIMPER, WIRE	1

QTY	REV	DESCRIPTION	ITEM NO		
1	-	A	1-456405-2	CRIMPER, WIRE	1

QTY	REV	DESCRIPTION	ITEM NO		
1	-	A	1-456405-2	CRIMPER, WIRE	1

QTY	REV	DESCRIPTION	ITEM NO		
1	-	A	1-456405-2	CRIMPER, WIRE	1

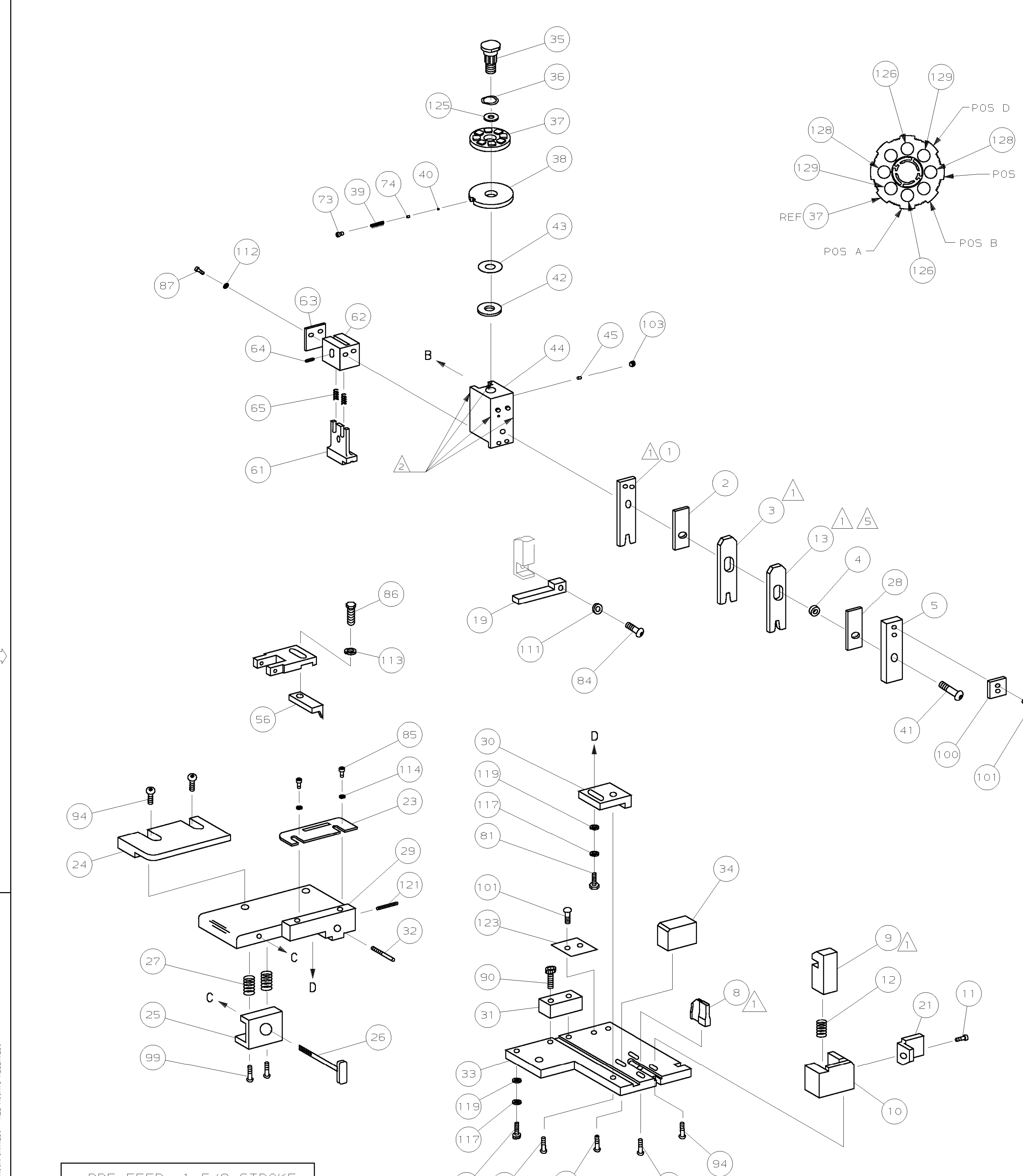

- 1 RECOMMENDED SPARE PARTS.
- 2 GREASE LIGHTLY.
- 3 ITEM NOT SHOWN
- 4 CUT TO LENGTH AT ASSEMBLY.
- 5 INSTALL ITEM 13 WITH RADIUS SIDE FACING WIRE CRIMPER.

