

NOT FOR IR REFLOW PROCESS

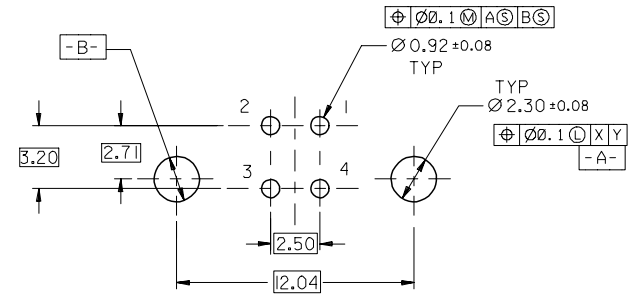
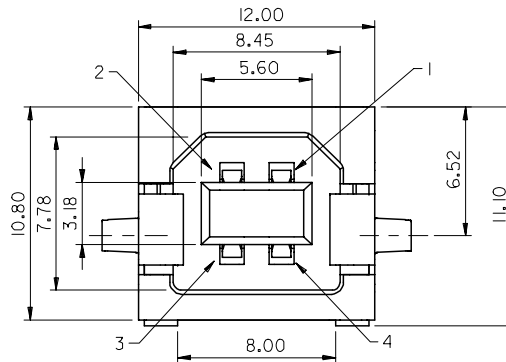
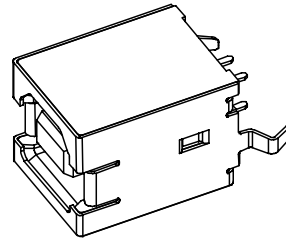
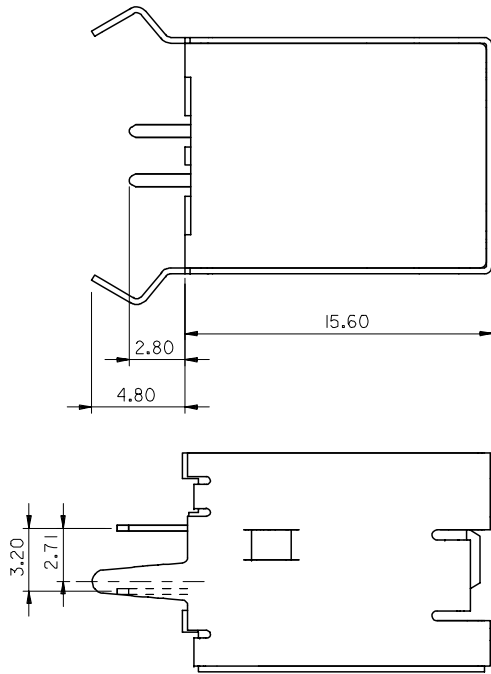

RECOMMENDED PCB LAYOUT

NOTES :

1. MATERIAL :

HOUSING : HIGH TEMP. NYLON , GLASS FIBRE FILLED, UL94-V0 , COLOR:BLACK
POLYESTER , GLASS FIBRE FILLED, UL94-V0 , COLOR: WHITE

TERMINAL : PHOSPHOR BRONZE
METAL SHELL : COPPER ALLOY

2. PLATING :

TERMINAL :
CONTACT AREA : (a) GOLD FLASH,
(b) GOLD (Au), THICKNESS = 30 MICROINCH MINIMUM,
/0.76 MICROMETER MINIMUM.

SOLDER TAIL : (a) TIN-LEAD(Sn-Pb)ALLOY,
THICKNESS= 150 MICROINCH MINIMUM .
/3.8 MICROMETER MINIMUM.
(b) PURE TIN PLATING
THICKNESS= 50 MICROINCH MINIMUM
/1.27 MICROMETER MINIMUM.

UNDER PLATE : NICKEL (Ni), THICKNESS= 50 MICROINCH MINIMUM.
/1.27 MICROMETER MINIMUM.

METAL SHELL :
(a) TIN-LEAD (Sn-Pb) ALLOY, THICKNESS= 100 MICROINCH MINIMUM,
/2.54 MICROMETER MINIMUM.
(b) PURE TIN PLATING, THICKNESS= 50 MICROINCH MINIMUM
/1.27 MICROMETER.

UNDER PLATE : NICKEL (Ni), THICKNESS= 50 MICROINCH MINIMUM.
/1.27 MICROMETER MINIMUM.

3 RECOMMENDED PCB THICKNESS : 1.60±0.05 mm

4 PRODUCT SPECIFICATION : REFER TO PS-67998-0000

PART NUMBER LEGEND:

P/N	COLOR	CONTACT PLATING	SHELL AND SOLDER TAIL PLATING
67171-0000	BLACK	GOLD FLASH	TIN-LEAD PLATING
67171-0001	BLACK	0.76 MICROMETER/ 30 MICROINCH GOLD	
67171-2000	BLACK	GOLD FLASH	PURE TIN PLATING (LEAD-FREE)
67171-2001	BLACK	0.76 MICROMETER/ 30 MICROINCH GOLD	
67171-3000	WHITE	GOLD FLASH	
67171-3001	WHITE	0.76 MICROMETER/ 30 MICROINCH GOLD	

DELETE NON ROHS PRODUCTS EC NO: SH2006-0759 DRWN: FANG05 CHKD: HWANG APPR: JNCHEN	2006/10/26 2006/10/28 2006/11/14	DESCRIPTION REV	QUALITY SYMBOLS	GENERAL TOLERANCES (UNLESS SPECIFIED)	DIMENSION STYLE	SCALE	DESIGN UNITS	THIRD ANGLE PROJECTION
			$\nabla = 0$ $\nabla C = 0$	mm INCH	MM ONLY	4:1	METRIC	
			4 PLACES ± --- ± --- 3 PLACES ± --- ± --- 2 PLACES ± 0.25 ± --- 1 PLACE ± 0.25 ± ---	VL IN DATE 1998/05/06	DRAWN BY DATE VL IN 1998/05/06	TITLE		
			ANGULAR ± 3 °	CHECKED BY DATE VL IN 1998/05/06	APPROVED BY DATE MEGA LIN 1998/05/06	USB B VERTICAL CONNECTOR		
			DRAFT WHERE APPLICABLE MUST REMAIN WITHIN DIMENSIONS	MATERIAL NO.	DOCUMENT NO.	MOLEX INCORPORATED		
G	SIZE A3	SEE CHART	SD-67171-001	SHEET NO. 1 OF 1				