

REV	ECN	APP'D
-	5663	J. TON
A	5706	J. TON
B	5720	J. TON
C	5796	J. TON 4-11-06

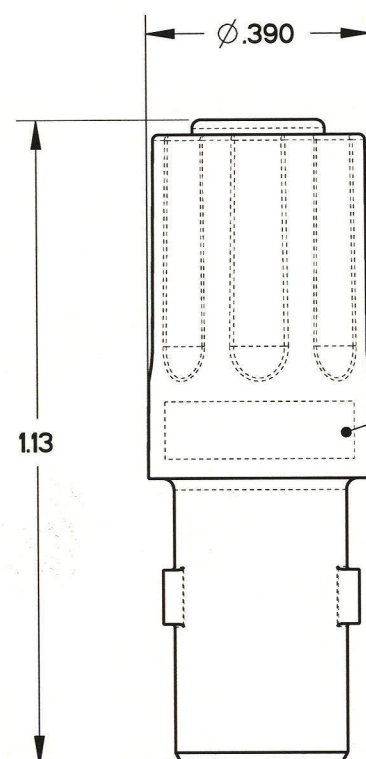
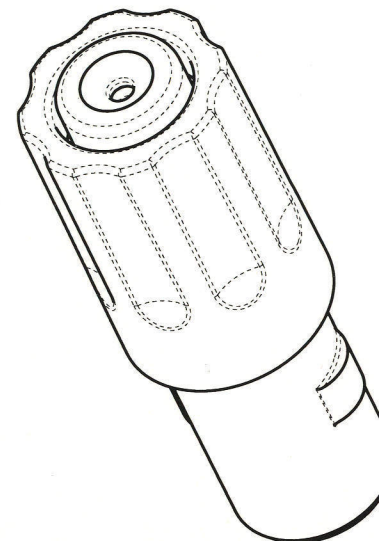
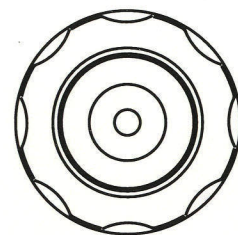

PART MARKING AS FOLLOWS:

BACC63DG0116SX APCD
YYWW SJS5161XX

DATE CODE

SEE TABLE 1 FOR FULL PART NUMBERS

NOTES:

- MATERIALS:
HOUSING: PA 6/6
CONTACT RETAINER: STAINLESS STEEL
GROMMET: SILICONE RUBBER PER A-A-59588
- OPERATING RANGE:
TEMPERATURE: -65 °C TO 160 °C
INSULATION RESISTANCE: 5000 MEGOHMS MINIMUM
DIELECTRIC WITHSTANDING VOLTAGE: 1500 VRMS SEA LEVEL
200 VRMS @100,000 FT. ALTITUDE

CURRENT RATING: 13 AMPS
VIBRATION: PER EIA-364-D METHOD 28
- ACCEPTS (1) M39029/56-352 SOCKET CONTACT (NOT INCLUDED)
- CONTACT RETENTION - MUST LOCK 25 LBS RET.
- LOCKING FEATURE - NO BREAK 25 LBS

TABLE 1 - PART NUMBER SCHEME

APCD PART#	BACC PART#	COLOR
SJS516100	BACC63DG0116SB	BLUE
SJS516110	BACC63DG0116SR	RED

DIMENSIONS ANSI Y14.5M UNITS: INCHES Pro/E FILE	TOLERANCES .XX ±0.01 .XXX ±0.005 ANGLES ±1.0°	PROJECTION 	Amphenol Pcd SPECIFICATION DRAWING		TITLE IN-LINE JUNCTION SINGLE WIRE, SIZE 16 PLUG		
			ENGR S. STONE 10/19/05	CHKD J. TON 10/19/05	APPD J. TON 10/19/05	SIZE B	DWG NO. SJS516100
ORIGINAL 	THIS DOCUMENT CONTAINS PROPRIETARY INFORMATION WHICH IS THE CONFIDENTIAL PROPERTY OF AMPHENOL PCD INC., PEABODY, MA			CODE: 58982	SCALE: 3:1	SHEET 1 OF 1	

SJS516100

SJS516100