

PRODUCT NUMBER	PITCH
VFxx70x100J0G	5.00 mm

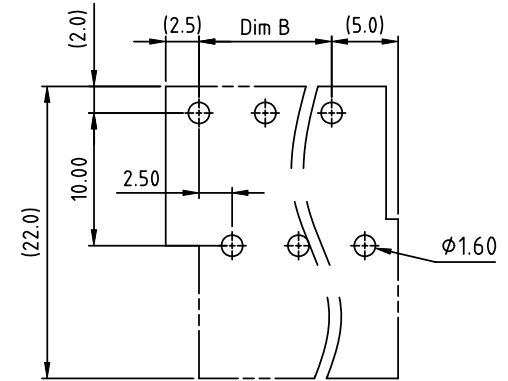

RECOMMENDED P.C.B LAYOUT
TOP VIEW

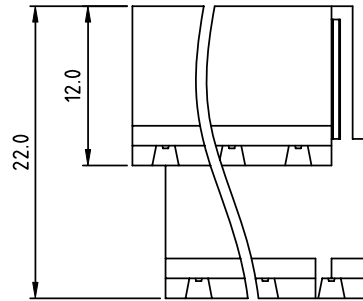
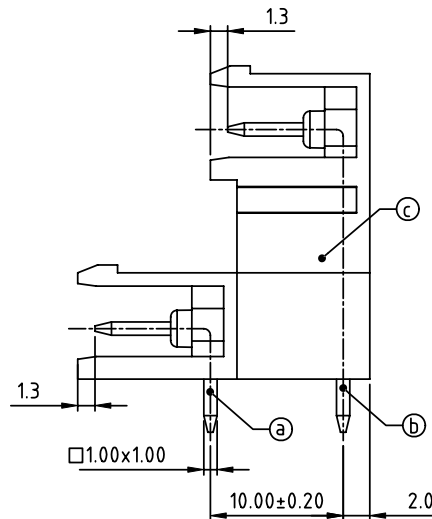
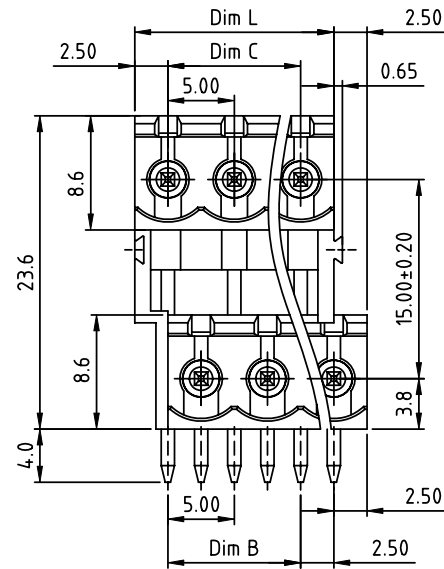

Material:

- Item ① Short pin: Copper, Tin plated
- Item ② Long pin: Copper, Tin plated
- Item ③ Terminal (housing): Thermoplastic (UL94V-0)

Electrical cULus

- Voltage rating: 300VAC
- Current rating: 10A
- Withstanding Voltage: 1.6KV
- Operating temperature: -40°C to +115°C
- Soldering temperature: 260°C±5°C/5 Sec
- Safety Approval: cULus

PART NO.: VF xx 70 x 1 00J0 G

Dimension	
Dim L	N/2×5.0
Dim B	(N/2-1)×5.0
Dim C	(N/2-1)×5.0

N=Number of poles	
Poles	Tolerance
2×2P-2×5P	±0.15
2×6P-2×10P	±0.20
2×11P-2×15P	±0.25
2×16P-2×20P	±0.30
2×21P-2×24P	±0.35

	Color	RoHS compliant (lead<4% in copper Alloy)
Solid block	0 Black (RAL9005)	
No. of poles	2 Red (RAL3001/D)	
04 2x2poles	3 Orange(RAL2011/P)	
06 2x3poles	4 Yellow(RAL1018/A)	
... ..	5 Green(RAL6018/T)	
48 2x24poles	6 Blue (RAL5015/A)	
	8 Grey(RAL7035/D)	
	9 White(RAL1102)	
	C Green(RAL6018/U)	

mat'l. code				surface ASME Y14.5	tolerance ASME Y14.5	projection	product family
ltr	ecn	no	dr	date	tolerances unless otherwise specified	MM	TERMINAL BLOCK
					angles	scale	title
					X±0.5		TERMINAL BLOCK
					X.X±0.3		PLUGGABLE SOCKET, OPEN TYPE, RIGHT ANGLE
					X.XX±0.1		dwg no
					dr		VFxx70x100J0G
					enrg		sheet 1 of 1
					chr		size
					appd		A4
							type
							CUSTOMER Drawing
sheet index	revision	A					
	sheet	1					