

REV. NO.		DATE		ZONE		LTY		REVISIONS		DATE	APP'D
00	00										
REVISED PER EC 0513-0486-03											

- △ HOUSING & TINE PLATE - LIQUID CRYSTAL POLYMER (LCP), UL 94V-0, BLACK.
- 2. CONNECTOR SOLDER TAILS WILL ACCOMMODATE PRINTED CIRCUIT BOARD THICKNESS OF 0.8 TO 1.6 [0.031 TO .063].
- △ G, J, H INDICATE NUMBER OF POSITION MARKED ON ASSEMBLY. ALSO SEE TABLE.
- △ THIS PART IS TUBF PACKAGED.
- △ CONTACTS - PHOSPHOR BRONZE PLATED WITH MINIMUM GOLD THICKNESS (SEE TABLE) IN CONTACT AREA AND 0.0038 [0.000150] MINIMUM THICK TIN LEAD ON SOLDER TINES OVER 0.00127 [0.000050] MINIMUM THICK NICKEL UNDERPLATE.
- △ RETENTION LEGS - BRASS PLATED WITH 0.0038 [0.000150] MINIMUM TIN OVER 0.00127 [0.000050] MINIMUM NICKEL UNDERPLATE.
- △ RETENTION LEGS - BRASS PLATED WITH 0.0038 [0.000150] MINIMUM TIN OVER 0.00127 [0.000050] MINIMUM NICKEL UNDERPLATE.

PRELIMINARY
 NOT RELEASED FOR PRODUCTION

	△ △ △	86.13 [3.391]	82.33 [3.241]	83.27 [3.278]	60	120	61	0.00076 [0.000030]	5-57100-7
	△ △ △	41.68 [1.541]	37.88 [1.491]	38.82 [1.528]	25	50	26	0.00076 [0.000030]	5-57100-6
	△ △ △	35.33 [1.391]	31.53 [1.241]	32.47 [1.278]	20	40	21	0.00076 [0.000030]	5-57100-5
	△ △ △	86.13 [3.391]	82.33 [3.241]	83.27 [3.278]	60	120	61	0.00076 [0.000030]	5-57100-4 △
OBSELETE	△ △ △	124.23 [4.991]	120.43 [4.741]	121.37 [4.778]	90	180	91	0.00076 [0.000030]	5-57100-3
	△ △ △	98.83 [3.991]	95.03 [3.741]	95.97 [3.778]	70	140	71	0.00076 [0.000030]	4-57100-9
	△ △ △	135.93 [5.391]	133.13 [5.241]	134.07 [5.278]	100	200	101	0.00076 [0.000030]	4-57100-1
	△ △ △	111.53 [4.391]	107.73 [4.241]	108.67 [4.278]	80	160	81	0.00076 [0.000030]	3-57100-7
OBSELETE	△ △ △	92.48 [3.541]	88.68 [3.491]	89.62 [3.528]	65	130	66	0.00076 [0.000030]	3-57100-3
	△ △ △	86.13 [3.391]	82.33 [3.241]	83.27 [3.278]	60	120	61	0.00076 [0.000030]	2-57100-9
	△ △ △	73.43 [2.991]	69.63 [2.741]	70.57 [2.778]	50	100	51	0.00076 [0.000030]	2-57100-5
	△ △ △	60.73 [2.391]	56.93 [2.241]	57.87 [2.278]	40	80	41	0.00076 [0.000030]	2-57100-1
	△ △ △	53.11 [2.091]	49.31 [1.941]	50.25 [1.978]	34	68	35	0.00076 [0.000030]	1-57100-7
	△ △ △	48.03 [1.901]	44.23 [1.741]	45.17 [1.778]	30	60	31	0.00076 [0.000030]	1-57100-3
	△ △ △	41.68 [1.541]	37.88 [1.491]	38.82 [1.528]	25	50	26	0.00076 [0.000030]	57100-6
	△ △ △	35.33 [1.391]	31.53 [1.241]	32.47 [1.278]	20	40	21	0.00076 [0.000030]	57100-5
OBSELETE	△ △ △	28.98 [1.141]	25.18 [1.091]	26.12 [1.028]	15	30	16	0.00076 [0.000030]	57100-1
NOTES		C	B	A	6	J	H	GOLD	PART NO

DO NOT SCALE PRINT. UNLESS SPECIFIED DIMENSIONS IN mm (INCHES): TOLERANCES ON: 2 P.L. DEC ± - 3 P.L. DEC ± - ANGLES ± -	DR R-91-P9 A-10-1 CHC 10-3-89 N. JONES APP'D 12-4-88 T.P.PIZZOLO	AMP APP. INCORPORATED Part 1000, Pt. 1112
MATERIAL OFF NOTES	APP'D 12-4-88 J.B. WILKINSON PRODUCT SPEC 108-136/7	NAME PLUG ASSEMBLY, RIGHT ANGLE, BOARD-TO-BOARD CHAMP™ .050, SERIES 1
FINISH SEE NOTES	APPLICATION SPEC 114-5045 WEIGHT -	SIZE D 00779 SCALE 4:1
		DRAWING NO 557100 SHEET 1 OF 3

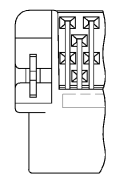

FOR 50, 130 POSITIONS ONLY

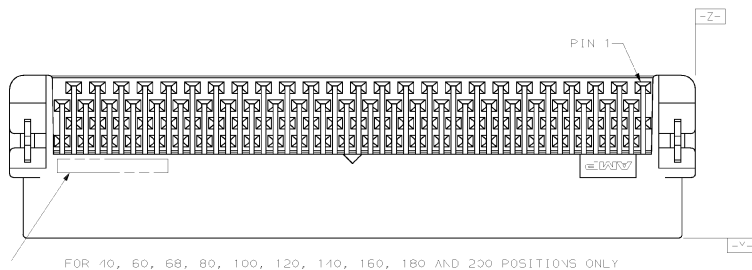

DATE CODE FOR 40, 60, 68, 80, 100, 120, 140, 160, 180 AND 200 POSITIONS ONLY

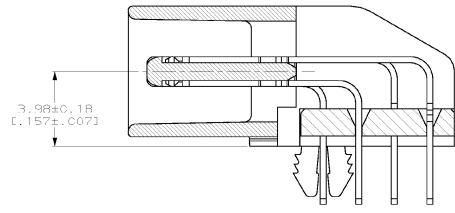
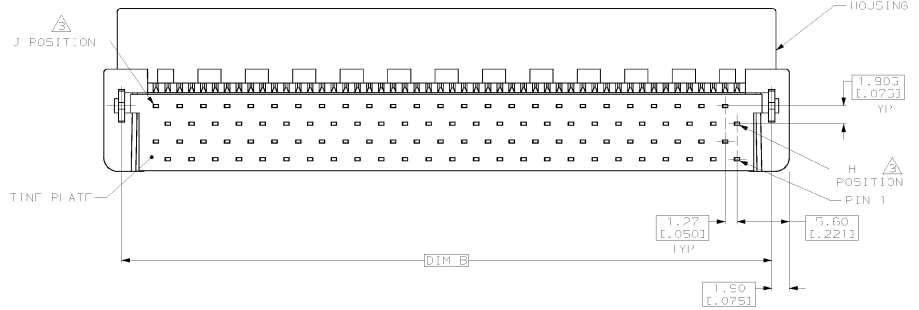
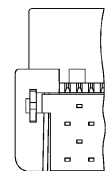
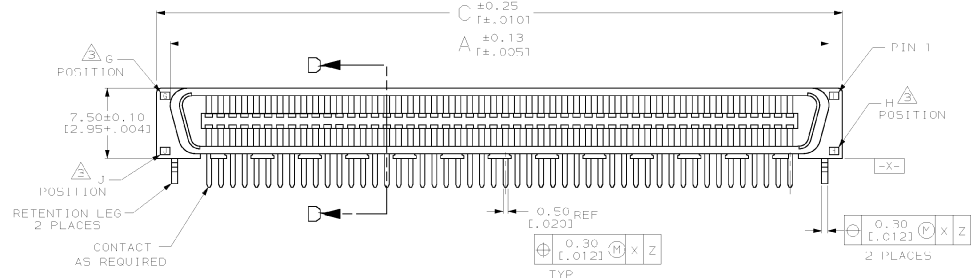

SECTION D-D
SCALE 8:1

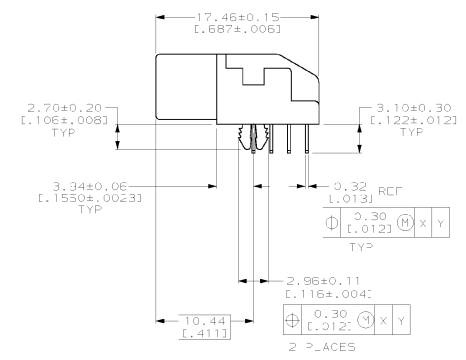

DESCRIPTION		PART NO	
DO NOT SCALE PRINT.	DR R-21-PS R. MARTIN	AMP INCORPORATED Merrillville, Pa. 15116	
DIMENSIONS IN mm (INCHES):	CHC 10-3-89 N. JONES		
TOLERANCES ON:	APPD 12-4-88 T. PIZZULO	NAME PLUG ASSEMBLY, RIGHT ANGLE, BOARD-TO-BOARD CHAMP™ .050, SERIES 1	
2 P.L.C. DEC ±			
3 P.L.C. DEC ±		SIZE CARE CODE DRAWING NO D 00779 557100	
ANGLES ±			
MATERIAL	APPD 12-4-88 J.B. WILKINSON	SCALE 4:1 SHEET 2 OF 3	
	PRODUCT SPEC		
FINISH	APPLICATION SPEC	CUSTOMER DRAWING	
	WEIGHT		

